



RINGWOOD - 12 BURWOOD AVENUE

- ⑤ Starting from: \$690,000
- 📍 Location: Ringwood, Melbourne, Australia
- 🕒 Expected Completion: End 2024

PROPERTY FEATURES

Ringwood has huge potential growth value. Ringwood includes upgraded Eastland Shopping Centre and COSTCO which allow you to enjoy shopping and dining.

Project Features: Project located in the "Green Belt" of Melbourne, and Eastfield Park is nearby. Rich Educational Resources: Ringwood Heights Primary School (84) & Ringwood Secondary College (88)

Convenient Transportation: Close to Ringwood & Heatherdale Train station. Easy access to M3 and Maroondah Hwy.

Brand new 2 and 3 bedroom townhouse

School Zone: Ringwood Heights Primary School (84) & Ringwood Secondary College (88)

10 mins driving distance to Ringwood Heights Primary School (84)

6 mins driving distance to Ringwood Secondary College (88)

10 mins walking distance to Costco Shopping Centre & Coles Ringwood & Bunnings Ringwood & restaurant etc

15 mins walking distance to Eastland Shopping Centre

5 mins walking distance to Staley Gardens

10 mins walking distance to Ringwood train station & Heatherdale train station

Project Basics

Type: Townhouse

Price Range: \$690,000 - \$790,000

Project Size: Contact us

Project Status: Under Construction

Represented By

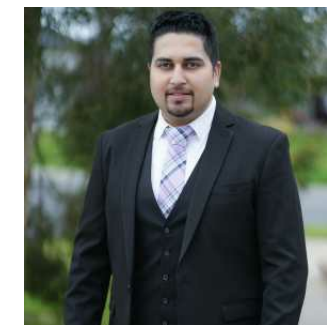

Rahul Malik

M7 Real Estate - Director

M: +61 0477013797

E: rahul@mseven.au

RINGWOOD - 12 BURWOOD AVENUE



Educations

<p>Rangeview Primary School</p> <p>TOP 7% ICSEA 1133</p>	1.81 KM
<p>Mitcham Primary School</p> <p>TOP 11% ICSEA 1091</p>	2.4 KM
<p>Antonio Park Primary School</p> <p>TOP 12% ICSEA 1104</p>	1.02 KM
<p>St James' School</p> <p>TOP 12% ICSEA 1129</p>	2.49 KM
<p>St John's School</p> <p>TOP 20% ICSEA 1136</p>	2.45 KM

Transportations

Sherbrook Ave/Whitehorse Rd (Ringwood)	0.18 KM
Charter St/New St (Ringwood)	0.2 KM
New St/Whitehorse Rd (Ringwood)	0.26 KM
Heatherdale Rd/Whitehorse Rd (Ringwood)	0.46 KM
Market St/Whitehorse Rd (Ringwood)	0.48 KM

Amenties

The Coach	0.13 KM
The Coach	0.13 KM
New Street Takeaway	0.14 KM
Zesty Lemon	0.14 KM
Pipe Bands Victoria	0.14 KM
Crush Beverages Pl	0.16 KM
McCafe	0.17 KM
Project Clothing	0.18 KM

More Information



Scan QR code to access more renders, videos maps and to download project files.



Rahul Malik
 Mobile: +61 0477013797
 Email: rahul@mseven.au

RINGWOOD - 12 BURWOOD AVENUE



More Information



Scan QR code to access more renders, videos maps and to download project files.

Featured Units

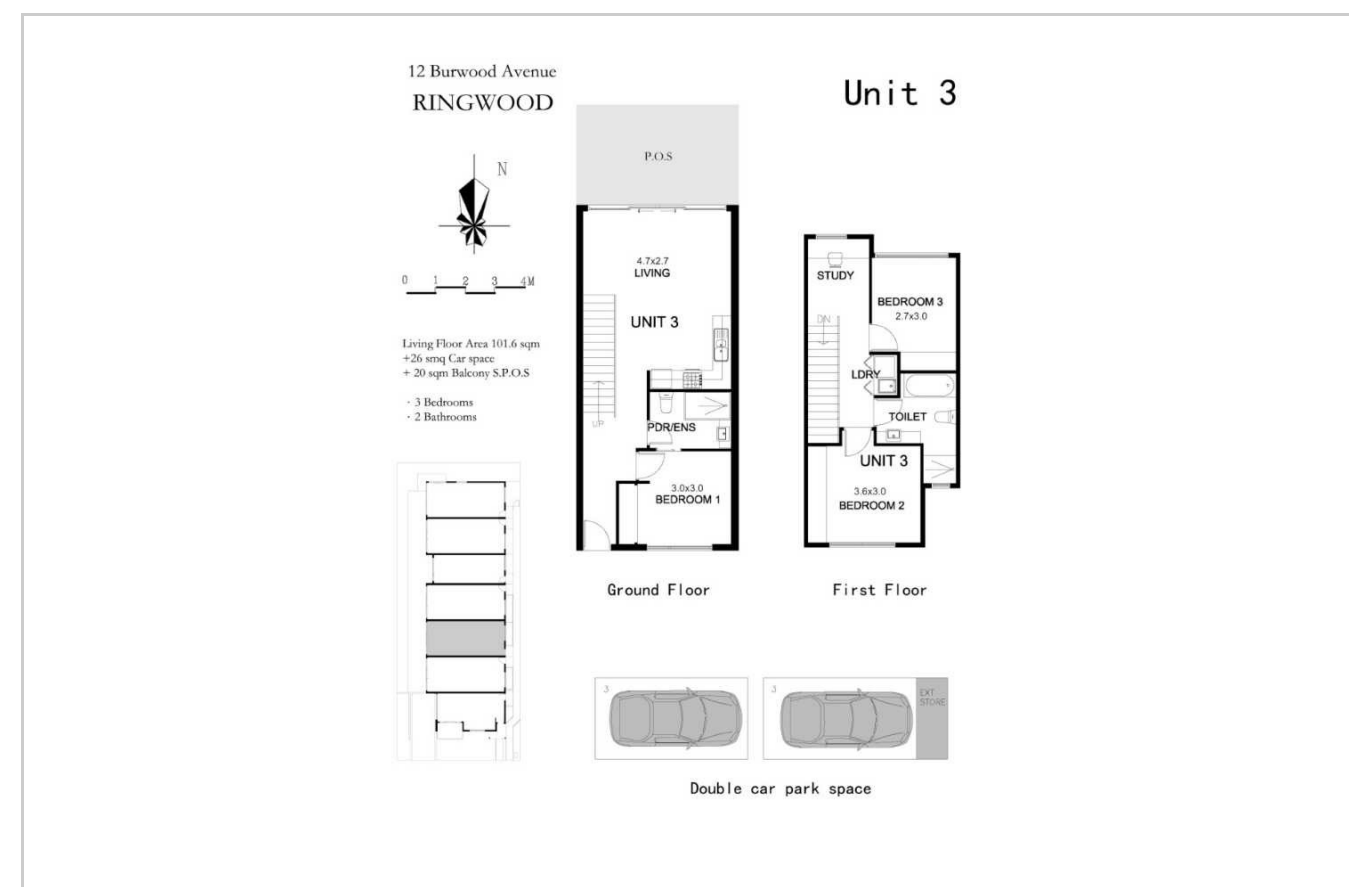
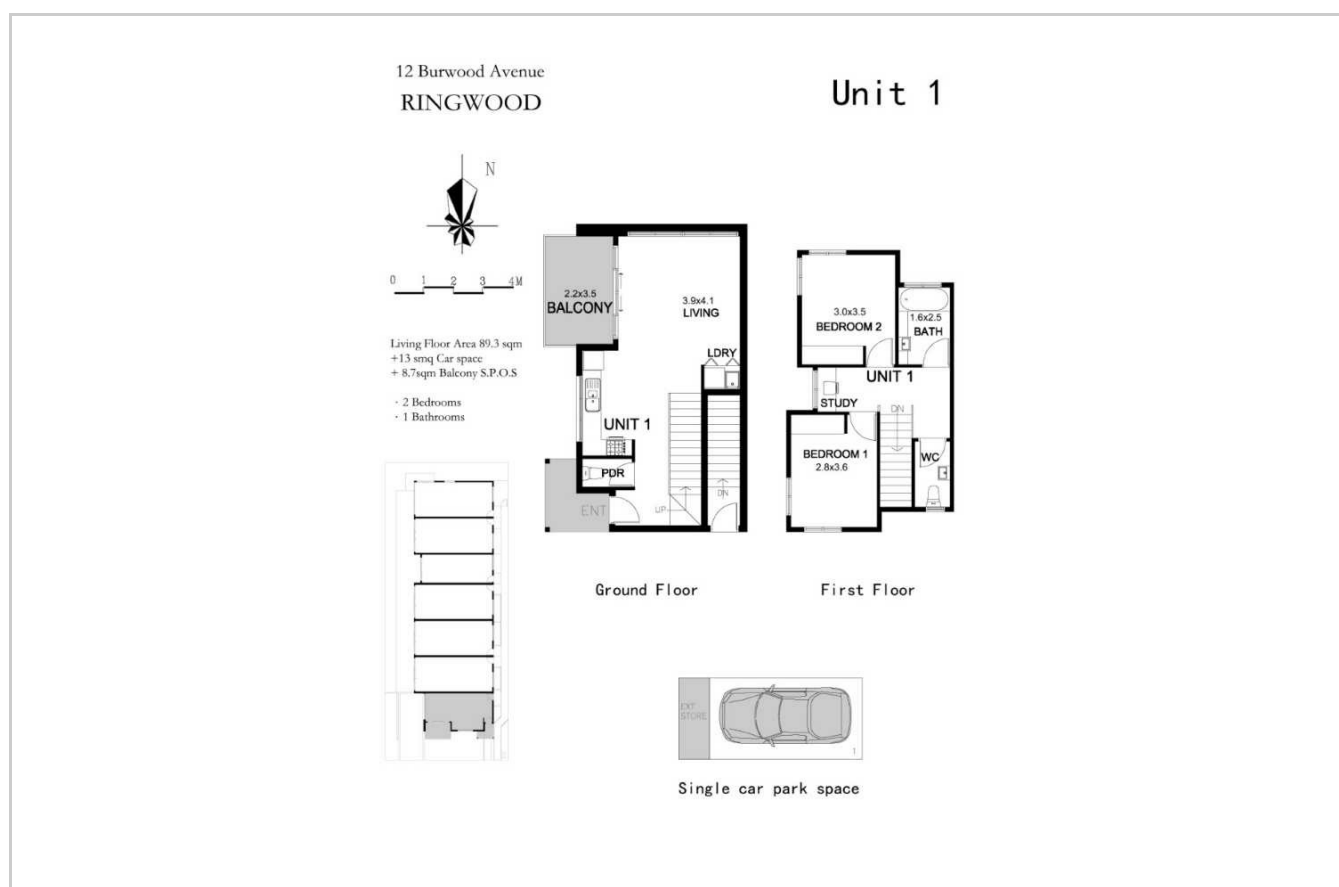

Unit 1 2 - 2 1
Price: \$720,000 Type: Townhouse
Total Size: 89.3sqm
Internal: 89.3sqm

Unit 3 3 - 2 2
Price: \$825,000 Type: Townhouse
Total Size: 101.6sqm
Internal: 101.6sqm

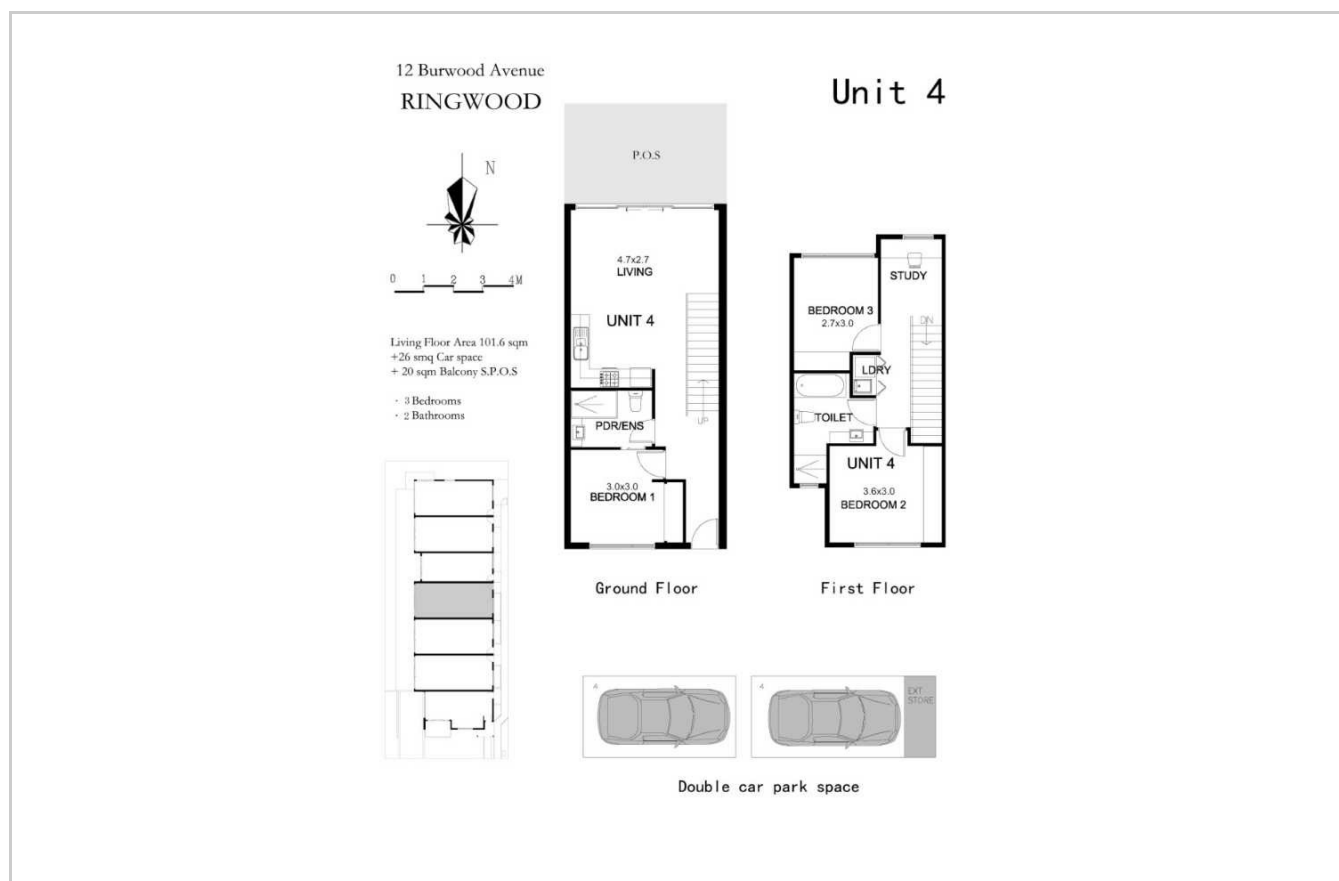

Unit 4 3 - 2 2
Price: \$790,000 Type: Townhouse
Total Size: 101.6sqm
Internal: 101.6sqm

